

Pro X Header® ~ Member Selection & Installation Instructions



ProX Header®
Manufactured by:
Brady Construction Innovations, Inc.
For More Information call: 1-888-475-7875

Pro X Headers have a dramatic advantage over multi-piece, (stud and track) built-up headers.

1. Select the member best suited for specific job conditions.
2. Count the Openings on the plans and determine the rough opening size via Finished Opening Frame Cut Sheets.
3. Order your ProX Headers at the specified rough opening lengths, **NO CUTTING** and **FAST INSTALLATION!**

Follow the directions below, to achieve your field crew's [maximum] efficiency and improve your bottom line.

STEP 1 ~ Pre-Planning and Document Review

Review the project documents and determine the wall load performance criteria (i.e. 5psf, 10psf and /or L/360, L/240)

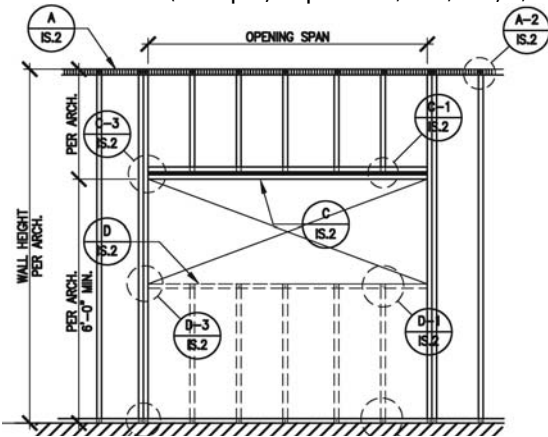

The above information can be sourced through the project documents, plans and specifications or RFI the "Architect / Engineer of Record"

STEP 2 ~ Member Selection

- A. Review the ProX Header, Architectural and Engineering Project Submittal Package, "Span Tables" and identify the correct load and opening span.
- B. Select the Pro X Member that meets the requirements of the project specific conditions.
- C. Option - Enter project data into Online Member Selector

Max. Opening Span (ft)	Lateral Pressure Deflection Limit ¹	Typical Interior Walls			Typical Exterior Walls					
		5 psf ¹			15 psf ²			25 psf ²		
		L/240	L/360	L/480	L/240	L/360	L/480	L/240	L/360	L/480
3' - 6"	No Insert With Insert ³	50' - 0" 50' - 0"	50' - 0" 50' - 0"	50' - 0" 50' - 0"	35' - 8" 35' - 8"	35' - 8" 35' - 8"	35' - 8" 35' - 8"	21' - 5" 21' - 5"	21' - 5" 21' - 5"	21' - 5" 21' - 5"
5' - 0"	No Insert With Insert ³	50' - 0" 50' - 0"	49' - 9" 49' - 9"	37' - 4" 37' - 4"	8' - 3" 8' - 3"	8' - 3" 8' - 3"	8' - 3" 8' - 3"	- -	- -	33' - 8" 33' - 8"
6' - 6"	No Insert With Insert ³	19' - 0" 48' - 4"	19' - 0" 35' - 1"	17' - 0" 26' - 3"	- -	8' - 6" 8' - 6"	8' - 6" 8' - 6"	- -	- -	14' - 5" 14' - 5"
10' - 0"	No Insert With Insert ³	9' - 3" 9' - 3"	- -	- -	- -	- -	- -	- -	- -	- -
12' - 6"	No Insert With Insert ³	- -	- -	- -	- -	- -	- -	- -	- -	- -
15' - 0"	No Insert With Insert ³	- -	- -	- -	- -	- -	- -	- -	- -	- -

The Span Tables will cover most any interior or exterior condition. For assistance contact Brady Construction Innovations @ 1-888-475-7875

STEP 3 ~ Order by SSMA Nomenclature

Review the ProX Header, Architectural and Engineering Project Submittal Package, "Product Identification Sheet" to identify the correct Pro X Member.



SAMPLE ~ 362 = 3 5/8"
362 X 425 - 54
 362 = member (width) depth / X = ProX Outer (style) / 425 = flange width...



362 XT 162 - 54
 362 = member (width) depth / XT = ProX Insert (style) / 162 = flange width...



362 XTC 425 - 54
 362 = member (width) depth / XTC = ProX Combo (style) / 425 = flange width...



362 Clip 150 - 54
 362 = member (width) depth / Clip = ProX Clip (style) / 150 = flange width...

Prepare project submittal package and submit to project architect or engineer of record for approval.

STEP 4 ~ Job-site Distribution

Distribute the ProX Headers, to the designated floor and zone in which it will be installed.

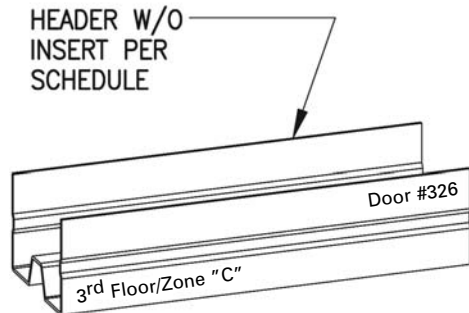

A key time saver is proper product identification and placement the first time, strive to eliminate moving material around. Using a Marker, write the floor / zone and door / opening number on each ProX Header.



See Our On-Line Member Selector

1-888-475-7875

www.ProXHeader.com

Building a Better Way.

Pro X Header® ~ Member Selection & Installation Instructions



ProX Header®
 Manufactured by:
 Brady Construction Innovations, Inc.
 For More Information call: 1-888-475-7875

STEP 5 ~ Installation ~ ProX Clip

Using a laser level, or other means, mark the height of the rough opening on both sides of the jamb studs and attach the ProX Clip in accordance with the ProX Clip matrix/screw requirement schedule. Screws can be driven from either direction.

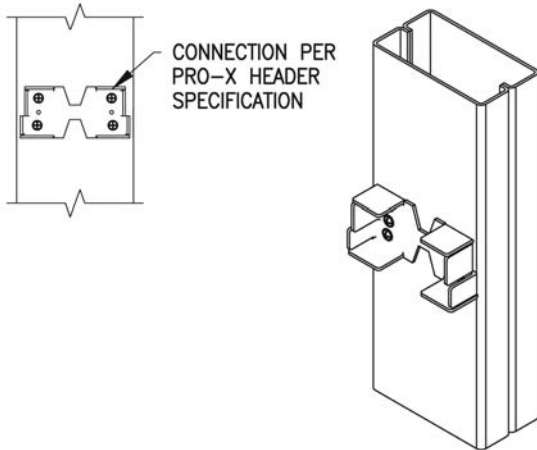

The ProX Clips can be installed on the jamb (as shown) or within the ProX Header. When installing within the ProX Header simply slide the header, with the clips attached within, into position and then screw attach the clip from the back side.

STEP 6 ~ Installation ~ Attach the ProX Header

Snap the ProX Header over the ProX Clip. The header will now hold itself in place. Make final plumbing and leveling adjustments and screw attach the header to the clip.

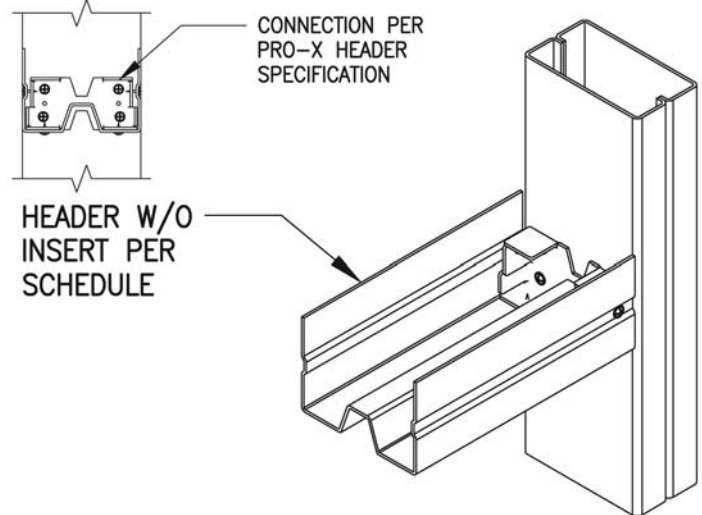

Screws attach the header to the clip, and may be driven from either direction. Finished Opening Frames (FOF) shall be installed in accordance with the FOF manufacturers installation instructions.

STEP 7 ~ Installation ~ Install the ProX Insert

If required, snap the ProX Insert into the ProX Header and in to place, screw attach the insert to the clip and the Pro X Outer in accordance with the notes on page 28.

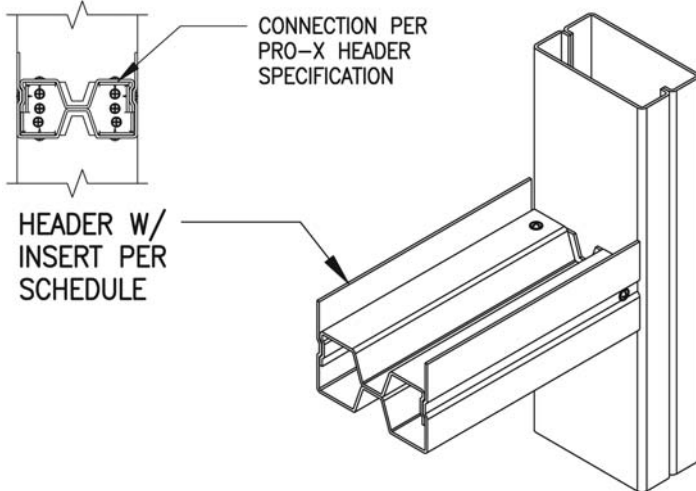

Screws attach the Insert to the clip in accordance with the ProX Clip matrix screw requirement schedule. Note: Additional SMS are required at the clip to jamb connection when using the ProX Insert.

STEP 8 ~ Installation ~ Install the Cripple Studs

Install the cripple studs per the wall schedule; ensure all screws are placed in accordance with the project documents.

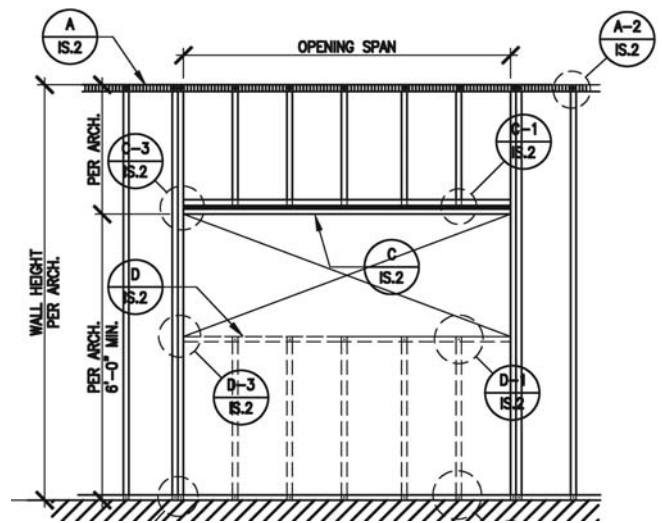

See Our On-Line Member Selector

1-888-475-7875

www.ProXHeader.com

Building a Better Way.